

### HORN-30 30W Weatherproof Horn Speaker

#### FEATURES

- ✓ UV stabilised ABS construction
- ✓ Stainless steel mounting hardware
- ✓ High power output for increased SPL
- ✓ Rust-free stainless steel bracket
- ✓ Compact & efficient design
- ✓ Ideal for use in wet areas
- ✓ Suitable for installation in exposed outdoor areas
- ✓ Five core cable connection



#### PRODUCT DESCRIPTION

The HORN-30 is an IP66 rated weatherproof horn speaker designed for indoor or outdoor installations.

It features marine grade stainless steel fixings & mounting bracket. Recommended for use in marine environments; ships, industrial plants and other harsh environmental applications.

#### INSTALLATION GUIDELINES

The HORN-30 is a 100V line horn speaker designed for direct connection to a commercial amplifier with 100V output. It is fitted with a 300mm 5 core cable. Each coloured cable core is connected to a power tap on the transformer. Selection is made by connecting between common and the required power tap cores.

The speaker is supplied with a stainless steel bracket and fixings ensuring rust-free performance even in harsh environments.

#### DIMENSIONS

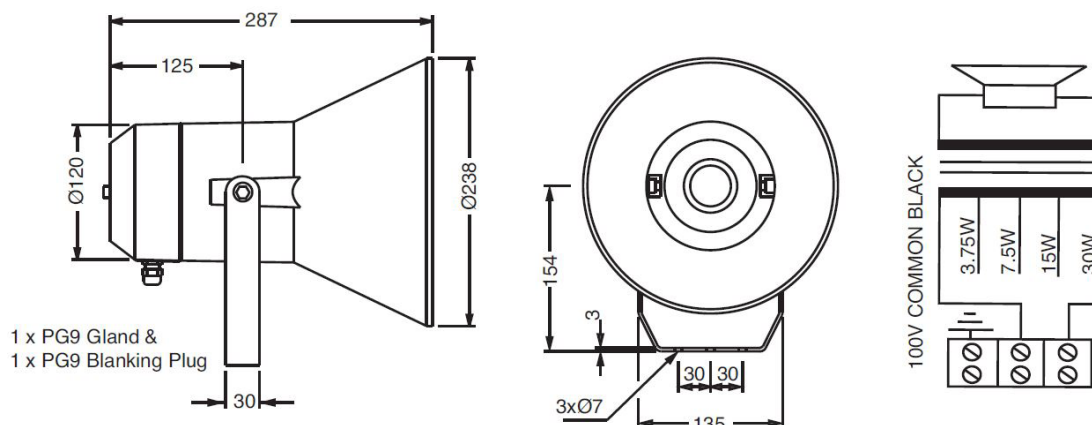

#### TECHNICAL SPECIFICATIONS

Rated power	30W
Power taps	3.75, 7.5, 15 & 30W
Transformer impedance	330Ω, 660Ω, 1.32kΩ, 1.875kΩ
Driver impedance	20Ω
Frequency range	330Hz-8kHz
SPL 1W @ 1m	103dB
SPL @ Full power	118dB
Acoustic power dB-PWL 1W @ 1kHz/2kHz	101dB/100dB
Dispersion at 1kHz/2kHz	110°/70°
Directivity axial Q factor 1kHz/2kHz	6.2/15.1
Dimensions	238mm Ø x 287mm
Net weight	2.3kg
Colour	Grey RAL7035
Material	ABS plastic housing with UV inhibitors
Mounting	Stainless steel U bracket

#### FREQUENCY RESPONSE

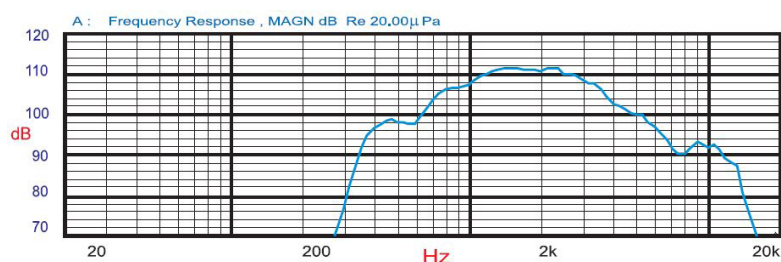

#### POLAR PLOT

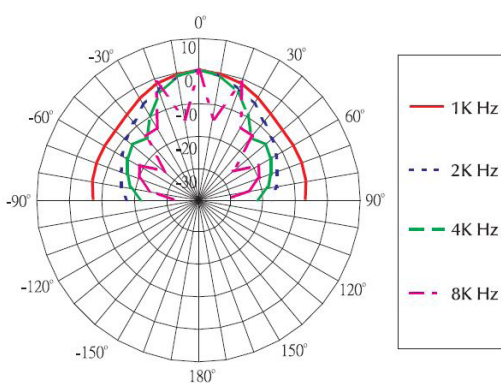

#### IMPEDANCE

