

FEATURES

- ✓ Intelligible voice and superior sound reproduction
- ✓ Low-profile design blends easily into any outdoor applications
- ✓ Ergonomic and stylish design
- ✓ AS ISO 7240-24 Certified
- ✓ SAI Global Certified
- ✓ IP66 compliant



PRODUCT DESCRIPTION

The LW-H15-7240 is a high performance 15W voice alarm horn loudspeaker. It provides a broad frequency response range, low distortion and high sound pressure level for accurate and intelligible broadcast of evacuation messages and high quality sound reproduction. It can be used in outdoor, dry or wet applications, providing reliable operations over wide temperature and humidity ranges. Its low profile, light grey colour design blends easily with most interiors into locations such as train stations, factories, campuses, and stadiums.

TECHNICAL SPECIFICATIONS

Max Power	25W
Rated Power	15W
Power Tapping	15W/10W/5W
SPL at 15W/1W (100Hz- 10kHz, 1m)	117dB/105dB
SPL at 15W/1W (100Hz- 10kHz, 4m)	105dB/93dB
Frequency Response (-10dB)	300Hz - 16kHz
Rated Input Voltage	100V/70V
Rated Impedance	667 Ω / 1k Ω / 2k Ω
Dimensions	213mm x 265mm
Weight	2.05kg
Colour	Grey (RAL7035)
Speaker Size	Compressed driver
Operating Temperature	-25°C to +55°C
Storage Temperature	-40°C to +70°C
Relative Humidity	Up to 95%

FREQUENCY RESPONSE

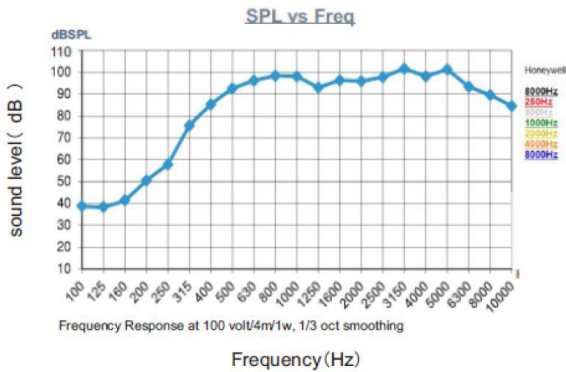

POLAR DIAGRAM

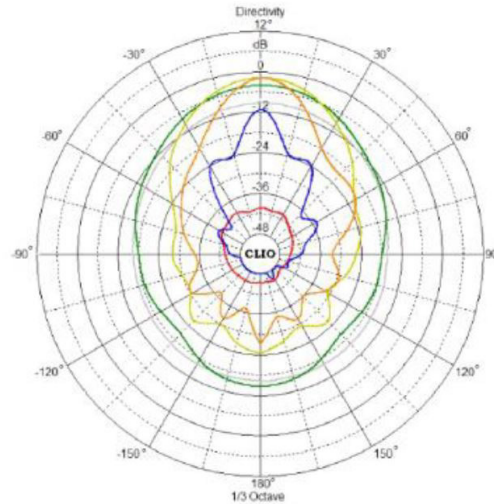

CIRCUIT DIAGRAM

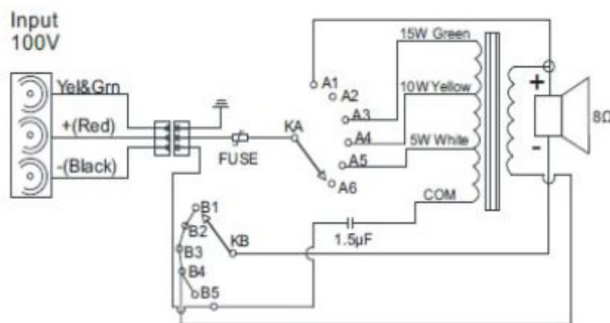

THREE-VIEW DIAGRAM

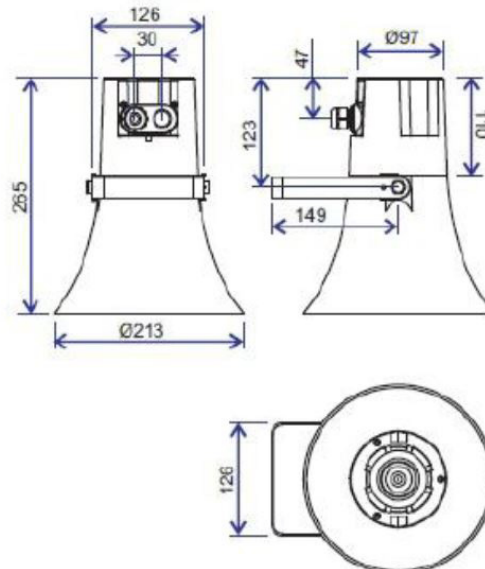

APPROVALS

- ✓ This horn speaker complies with AS/ISO7240.24.
- ✓ SAI Global: Certificate No. SMK40640 (refer to certificate for compliance)